

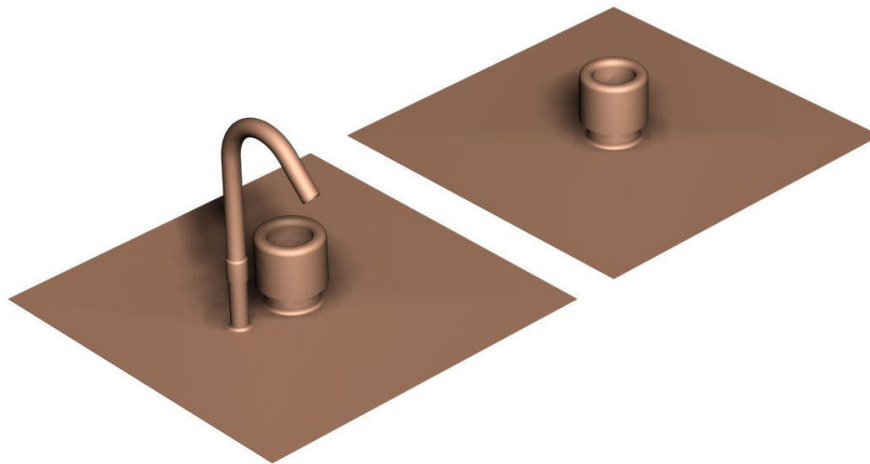

AET's unique Roof Pipe Flashing is made from a 16 mil all copper sheet with a 1-1/4" Tube stub for the pipe penetration. The 1/2" or 3/4" coolie caps allow for thermal expansion. The collector inlet flashing features just 1 stub for the pipe, but the outlet flashing features a copper gooseneck made from 1/4" copper pipe that extends three inches above the flashing and is designed to provide a leak free penetration for the 18/2 control wire. The key to ensuring a leak free penetration are the copper coolie caps and sized to tightly fit either 1/2" or 3/4" pipe. These act like an umbrella over the stubs and prevent water from entering the stub when soldered, allowing for pipe movement due to thermal expansion.

The flashings are installed with a bead of roofing cement on the underside along with roofing cement on the top side between the shingles and the flashing sheet. The flashing is secured to the roof with copper nails.



Material: Copper UNS 100 3/4" Hard
Pipe Sizes: 1/2" and 3/4"
Flashing Size: 8" x 8"
Thickness: 0.016"