

Technical data

UPS 15-58 FC/FRC

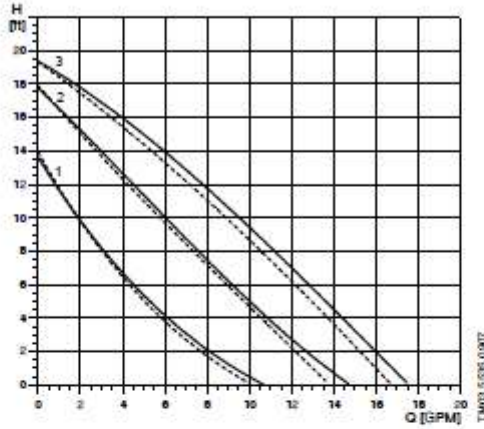

Flow range: 0-17 gpm
 Head range: 0-19.5 feet
 Motors: 2-pole, single-phase
 Max. liquid temperature: 230 °F (110 °C)
 Min. liquid temperature: 36 °F (2 °C)
 Max. system pressure: 145 psi (10 bar)

Model	Spd	Volts	Amps	Watts	Hp	Capacitor
UPS 15-58 FC/FRC	3	115	0.75	87	1/25	10µF/180 V
	2		0.66	80	1/25	
	1		0.55	60	1/25	

— Without check valve
 - - - With check valve

UPS 15-58 FC

UPS 15-58 FRC

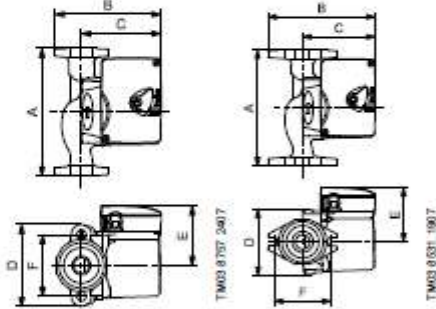

Approvals



Model type	Product number	Dimensions [Inches]						Connection type and size	Shipping weight [lb]
		A	B	C	D	E	F		
UPS 15-58 FC	59896341	6 1/2	5 1/4	4	4 3/16	3	3 5/32	GF 15/26 flange (2) 1/2" dia. bolt holes	7 1/4
UPS 15-58 FRC	59896343	6 1/2	5 1/4	4	4 3/16	3	3 5/32	GF 15/26 flange (2) 1/2" dia. bolt holes	7 1/4

Note: The check valve can be removed.
 Dimensions in inches unless otherwise noted.

Technical data

UP Series
UP 15-100F

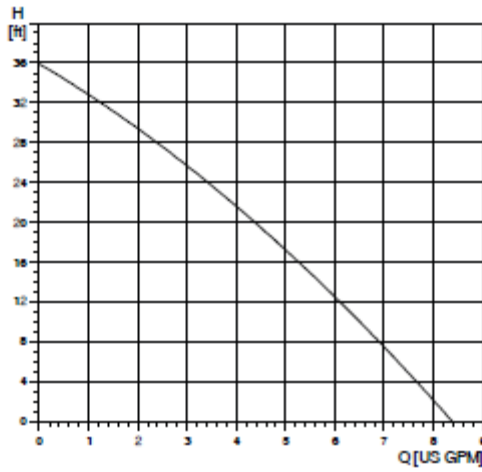

Flow range: 0-8.4 U.S. gpm
 Head range: 0-36 feet
 Motors: 2-pole, single-phase
 Max. liquid temperature: 205 °F (96 °C)
 Min. liquid temperature: 36 °F (2 °C)
 Max. system pressure: 145 psi
 Closed system

Model	Volts	Amps	Watts	Hp	Capacitor
UP 15-100F	115	1.1	135	1/25	12µF/180 V

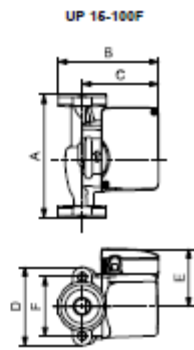

Model type	Product number	A	B	C	D	E	F	Connection type and size	Shipping weight [lbs]
UP 15-100F	59896300	6 1/2	5 1/4	4	4 3/16	3 1/4	3 5/32	GF 1 5/16 flange (2) 1/2" dia. bolt holes	7 1/4

The Pump we sell does not come with the timer illustrated here.

Technical data

UP Series
UP 15-10SU7P/TLC

Comfort system

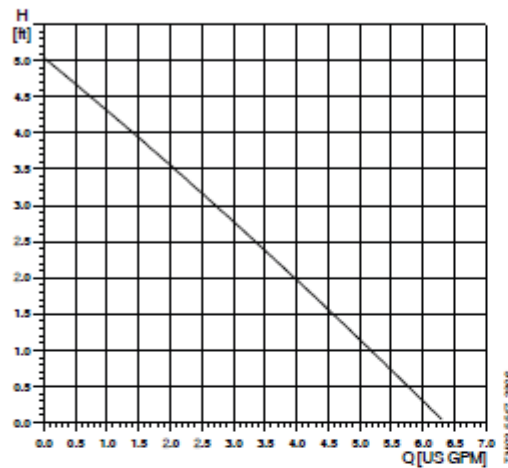

Flow range: 0-6.3 U.S. gpm
 Head range: 0-5.1 feet
 Motors: Single-phase
 Max. liquid temperature: 150 °F (66 °C)
 Min. liquid temperature: 36 °F (2 °C)
 Max. system pressure: 145 psi
 Open system

Model	Volts	Amps	Watts	Hp	Capacitor
UP 15-10SU7P/TLC	115	0.23	25	1/25	2µF/400 V

Approvals

- ANSI/NSF61
- IAPMO
- UPC
- UL

UP 16-10SU7P/TLC

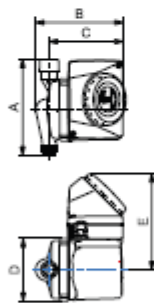

TM03 4062 3007

Comfort valve

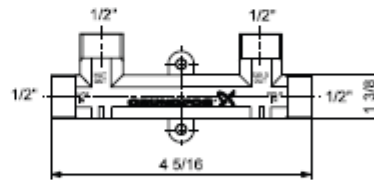

TM03 4063 3007

Model type	Product number	A	B	C	D	E	F	Connection type and size	Shipping weight [lbs]
UP 15-10SU7P/TLC	595916	5 7/16	6 1/4	5 1/2	3 7/16	3 1/4	4	3/4" M x 3/4" F NPT	5 1/2 lbs
Comfort valve	595926							1/2" M NPS (1/2" faucet)	2.8 lbs
Flex hose kit	599390							(2) 1/2" FIP x 1/2" FIP	-

Model type	Product number	Description
Comfort valves	595926	Box of 15 pieces
Comfort series kit	595916	1 pump and 1 valve, (2) 1/2" FNPS X 1/2" FNPS X 12" stainless steel flex hoses

Note: All models have a 10-foot 3-prong power cord.

